

Access Statement for the Cutty Sark

Please note all information contained within this document is accurate as of 01/02/24

Access Guide - *The Cutty Sark*

Planning your visit

The Cutty Sark is located in the centre of Greenwich on King William Walk, a short distance from the DLR station, multiple bus stops and the pier for transportation via the river, with the closest National Rail stations being **Maze Hill** and **Greenwich**.

The distance from **Cutty Sark DLR station** is 0.1 miles

The nearest bus stops are located on **King William Walk** at 0.1 miles, and **Greenwich Church Street** at 0.2 miles

The closest national rail station are **Greenwich Station** at 0.5 miles, and **Maze Hill** at 0.7 miles.

The Cutty Sark is located less than 100m from a tourist information centre, that can offer you further information on transportation in the area and around London.

There are public bike racks in front of the main entrance to the ship.

The closest car park is "*The Cutty Sark Gardens Car Park*", located underneath Cutty Sark Gardens at 0.1 miles.

Accessible DLR travel

Cutty Sark DLR station has step-free access. Please see Tube map on www.tfl.gov.uk for further information.

- The nearest DLR station is **Cutty Sark** which is 0.1 miles away

Accessible Rail travel

The SouthEastern line has trains running approximately every 10 minutes to London Cannon Street via London Bridge.

The line serves **Maze Hill** station which is 0.7 miles from *The Cutty Sark*.

For further Access information about **Maze Hill** please visit http://www.nationalrail.co.uk/stations_destinations/MZH.aspx

Greenwich Station in Greenwich town centre is 0.5 miles from *The Cutty Sark*. For further access information about **Greenwich station** please visit http://www.nationalrail.co.uk/stations_destinations/GNW.aspx

Greenwich and **Maze Hill** rail station platforms have step-free access via ramp, lifts or underpass. The ticket offices and car parks at these stations are also step free.

Accessible Bus Travel

Please check websites prior to visiting for up to date travel information.

Frequent bus routes operate around Greenwich. The nearest bus stops are located on **King William Walk** at 0.1 miles, and **Greenwich Church Street** at 0.2 miles

Accessible River Travel

Greenwich Pier is situated 120 metres from *The Cutty Sark*. Clippers from Greenwich Pier come approximately every 20 minutes. Uber Boat by Thames Clipper for Central London stop at:

- Canary Wharf / London Bridge / Bankside / Blackfriars / Embankment / London Eye
- Please see timetable for exact times at <http://www.thamesclippers.com/>
- For a more leisurely view of the Thames, City Cruises leave from Greenwich Pier approximately every 30 minutes from 10.00–17.40. Please see <http://www.citycruises.com/> for more information

Car Travel

- The car park is open to the general public at weekends but Blue Badge holders may use the designated parking bays on any day of the week. Parking is free for Blue Badge holders. Please call our switchboard on 0208 858 4422 or e-mail bookings@rmg.co.uk to book
- Limited pre-booked spaces are available and are payable via contactless payment at the car park entrance.
- The car park may also have some space available which can be paid for on arrival.
- There are 6 designated Blue Badge parking bay(s) within the car park.
- The dimensions of the designated parking bay(s) are 235cm x 490cm.
- The car park is tarmac leading onto a gritted non-slip.
- The car park does not have a height restriction barrier.
- If you do not have a Blue Badge and wish to park on the weekends the price is £10. This can be paid online or at the booth in the car park.
- The car park is in the open air on Park Row within the grounds of the museum, postcode SE10 9NF.
- The car park is located 0.4 miles from *The Cutty Sark*

Entrance

Entrance to *The Cutty Sark* requires the purchase of a ticket. A variety of options and combination tickets are available. For further information regarding tickets offered or for any queries regarding concessionary entry please visit www.rmg.co.uk or contact 020 8312 6608.

The main entrance to *The Cutty Sark* utilises automatic doors and is located at street level.

From the main entrance the ship can be reached via a bridge with a very slight incline, and the dry berth can be accessed either via lift or by stairs.

The doorway to the ship measures 100cm in width and there is a significant change in lighting when entering The Lower Hold, as it is dimly lit inside.

There is a lower height desk at the admissions area, at 75cm high.

There are hearing loops in place on both the main admissions desk and shop desk.



Smartify – Audio Tour

A free audio tour is available through downloading the Smartify app. This tour is available in a variety of languages and also has options for subtitles or British Sign Language.

There is an augmented reality section during the tour which allows you to view inside areas of the ship that are currently off-limits for essential conservation work.

It is recommended to download Smartify in advance and bring your own headphones as we are not able to offer any on site.

Getting around and recommended route

When inside the ship there is a recommended route in place, which will take you through the lower hold working your way up and around the tween deck, before reaching the main deck and then taking you to level -1 in the dry berth underneath the ship.

Please see the images below for width restrictions on the different levels and to familiarize yourself with the layout of the ship. (Zoom in for detail)

Lower Hold

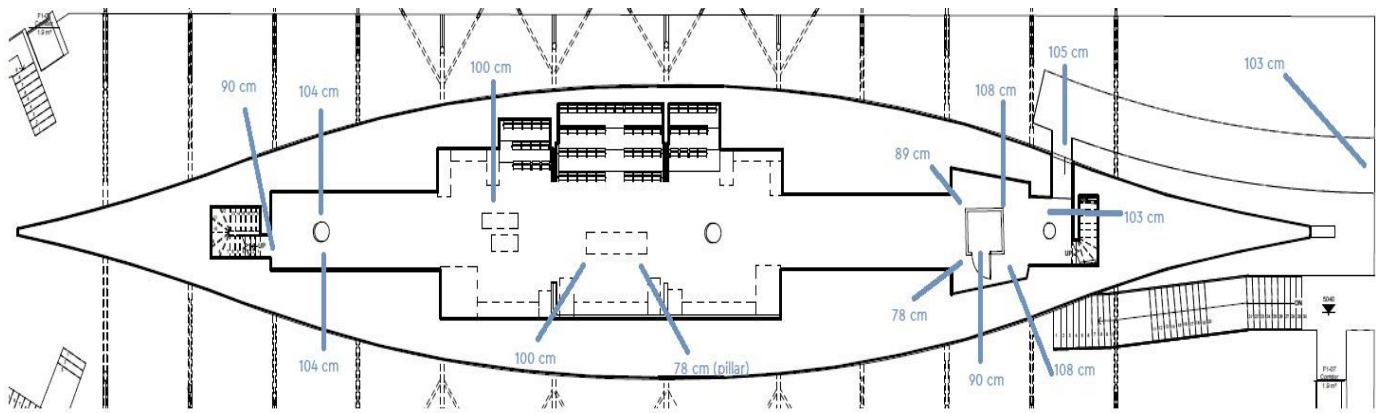

Tween Deck

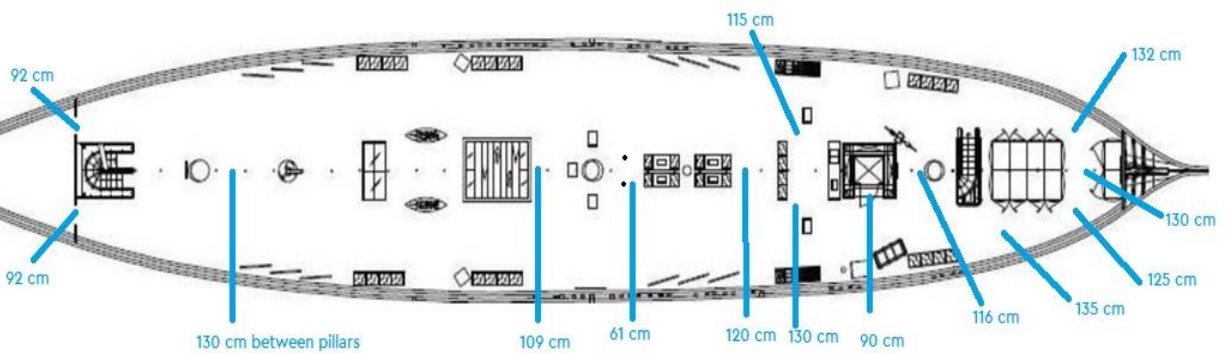

Main Deck

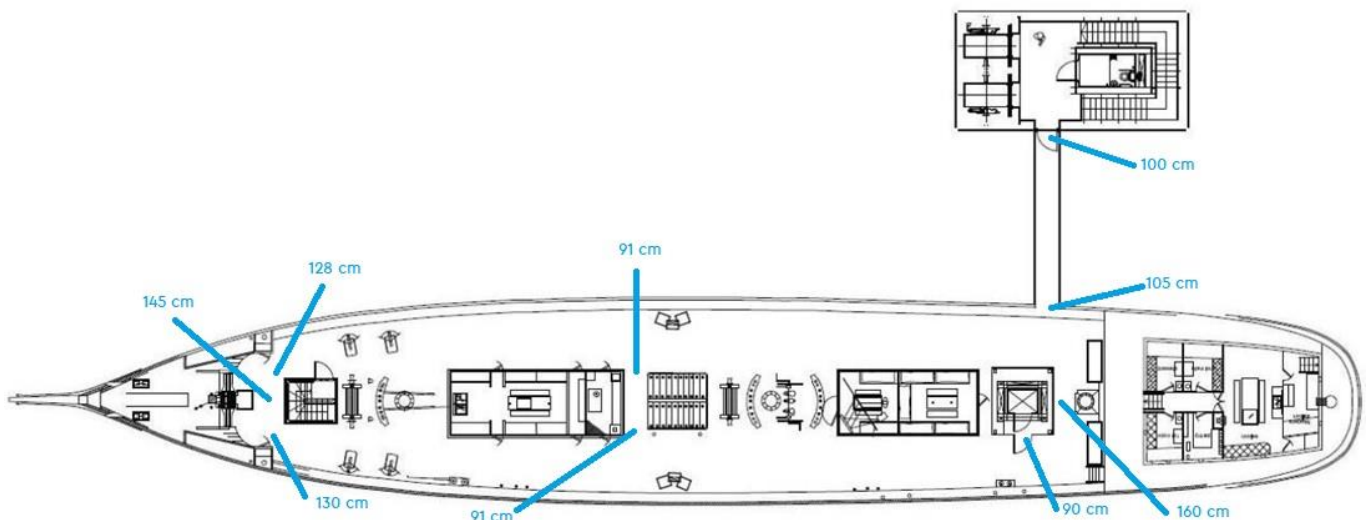

Getting around and recommended route

When inside the ship there is a recommended route in place. You will start your visit in *The Lower Hold* where you will learn about the tea trade and voyages of *The Cutty Sark*.

The Lower Hold is dimly lit and has some narrow sections, the tightest being 80 cm on the left of the lift, with a slightly larger 90cm on the other side.

The floor is wooden in the style of old tea-chests, and can be slightly uneven in places.

This level of the ship makes contains multiple audio interactives and videos, with the main information video having audio and subtitles.

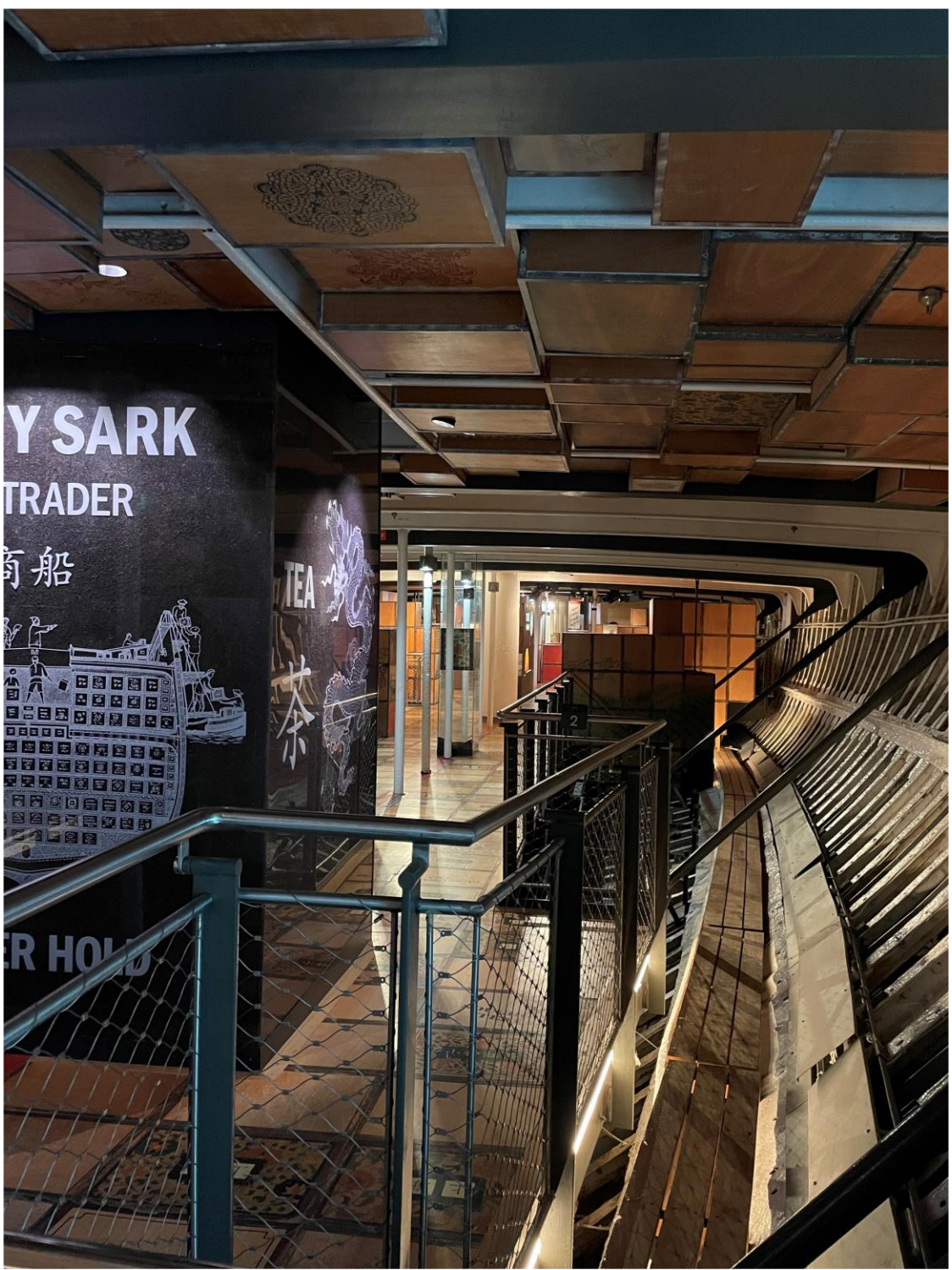

Then make your way up to *The Tween Deck* via the stairs or lift. The staircase at the back of the ship by the entrance has 12 steps, and the staircase at the front 12 steps.

Staircase is 80cm wide

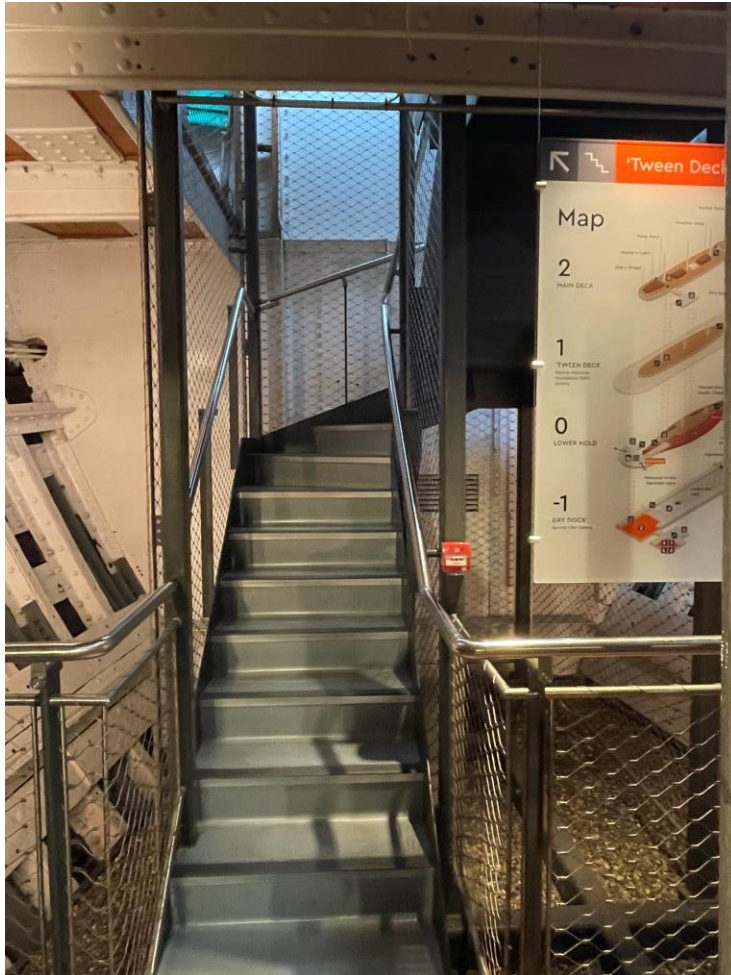

The Tween Deck

The Tween Deck will tell you more about the history of the ship and its time under Portuguese ownership, the daily lives of the crew, and its other cargoes.

The Tween Deck has a very low ceiling in places and a slight sloping gradient towards the sides of the ship.

From *The Tween Deck* you will make your way to *The Main Deck* via stairs or the lift.

The staircase connecting *The Tween Deck* and *Main Deck* has 12 steps, and also requires a change in direction whilst climbing.

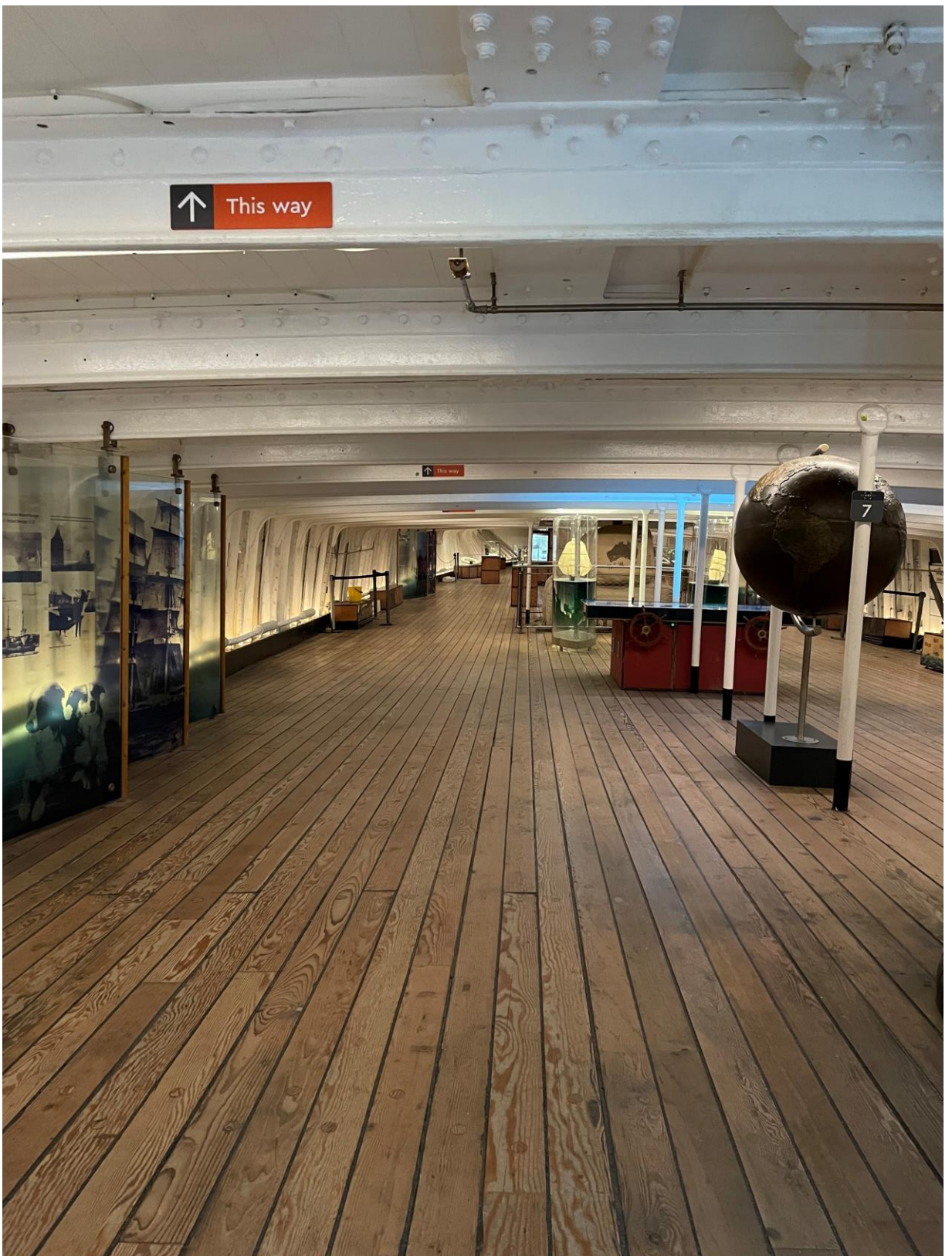

The Main Deck

The Main Deck is often visitors favourite part of the ship and will show you the crews' quarters, the rigging, and give you a real experience of life at sea



On the main deck there are certain areas that are only accessible via step access. The anchor deck and Liverpool house can only be accessed via a short staircases of 5 steps respectively. The majority of the deck is level and accessible step free.

Access to some cabins is restricted due to the frame of the door being raised 25cm from floor level.

The interior of the Liverpool House is able to be viewed via a video recording displayed next to the lift and via the AR section of our free Smartify tour.

An example of the staircase to the Captain's quarters is pictured below:

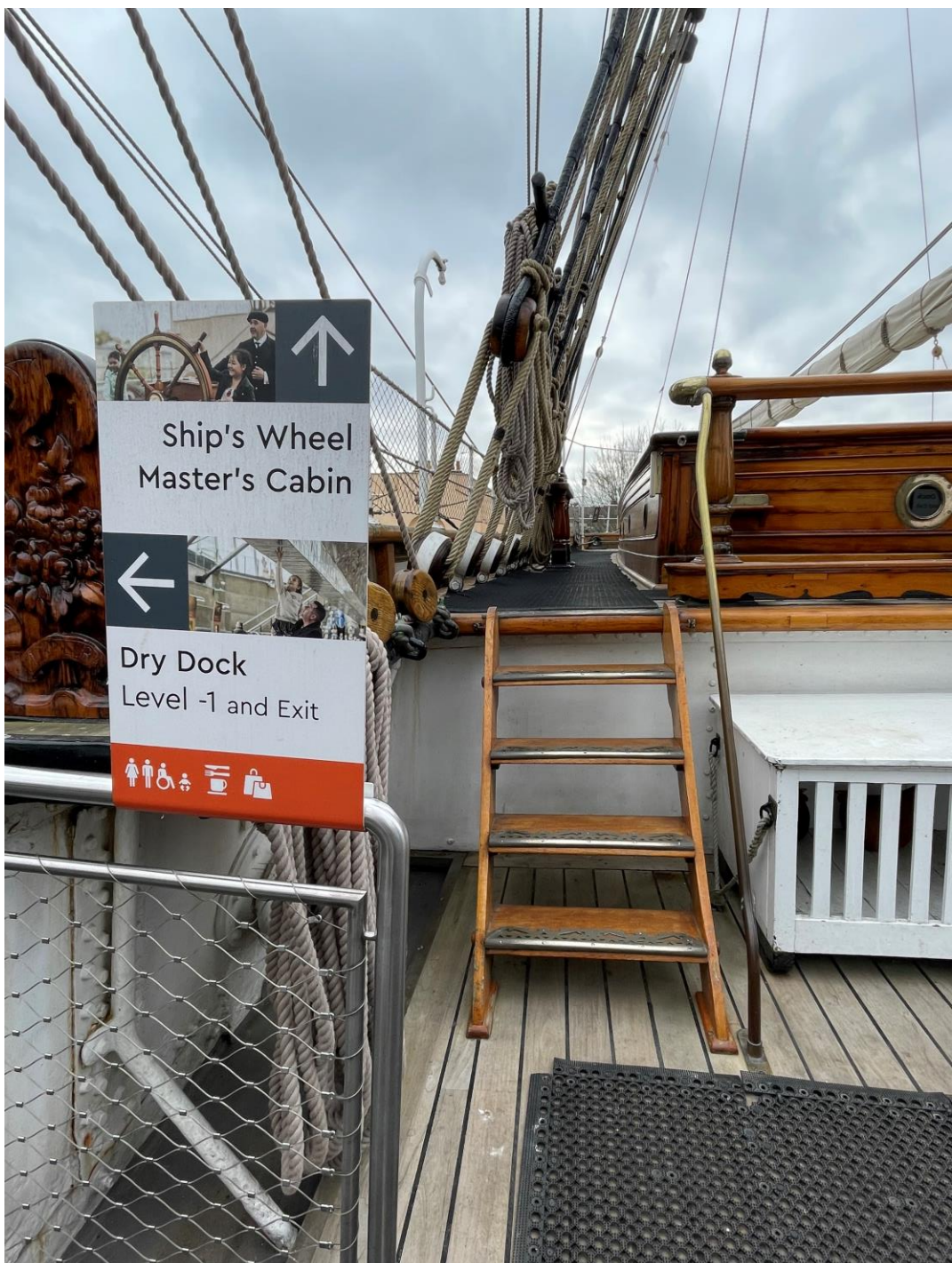

To leave the ship and make your way to *The Dry Berth* you will need to cross this bridge and then take the lift or stairs down to Level -1.

The width of this doorway is 100cm.

The staircase to take you from the main deck to the dry berth (-1) consists of multiple flights of stairs with a total of 61 steps.



The Dry Berth

In *The Dry Berth* you can walk underneath the hull of the ship and see the worlds largest collection of merchant navy figureheads.

The Dry Berth is predominantly lit by natural light

The flooring is tiled and level. Access to a viewing platform and the exit are accessible via platform lifts. Dimensions will be given on following pages.

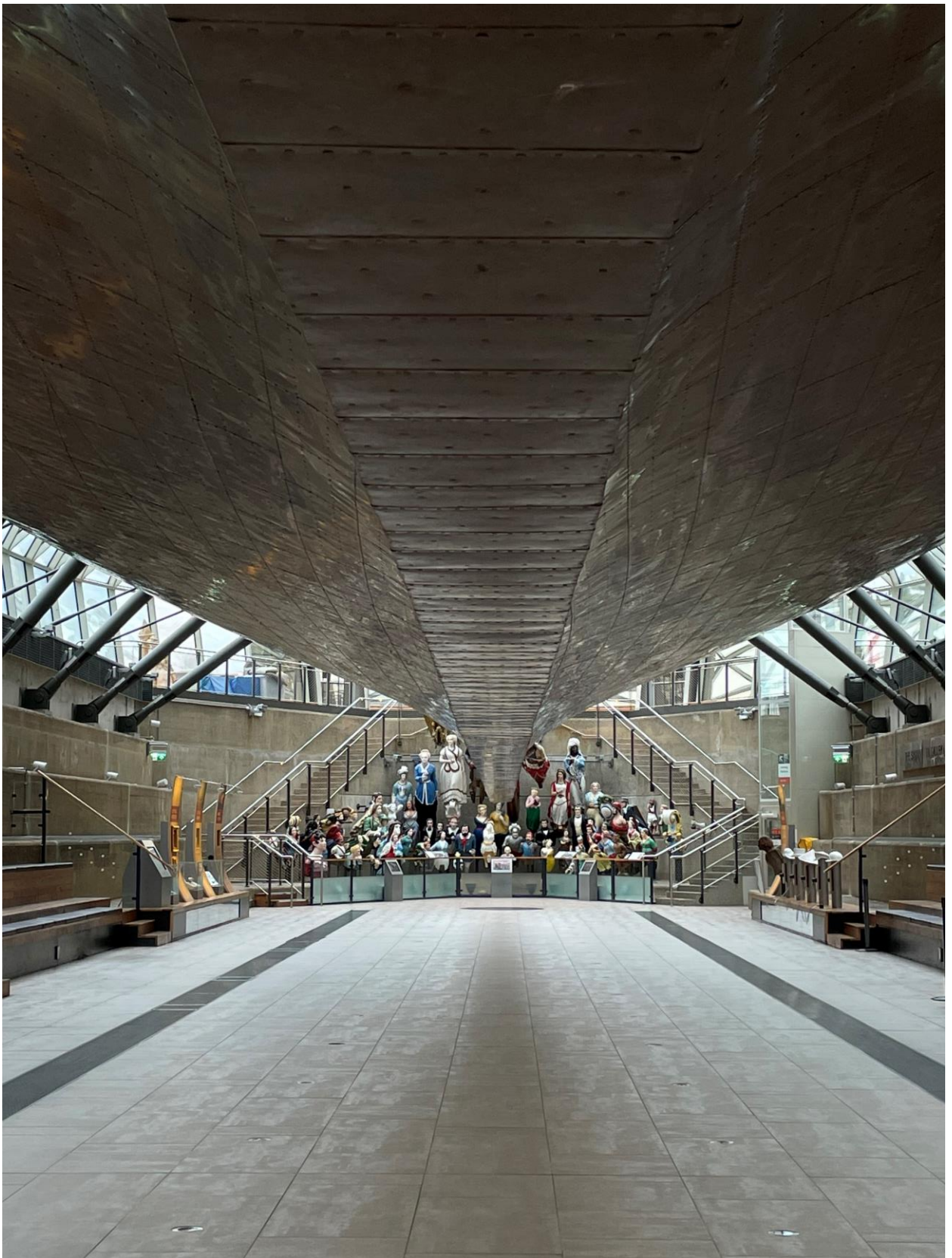

The café is situated in *The Dry Berth* underneath the hull of the ship. You will need to order at the counter and self-serve on a number of products.

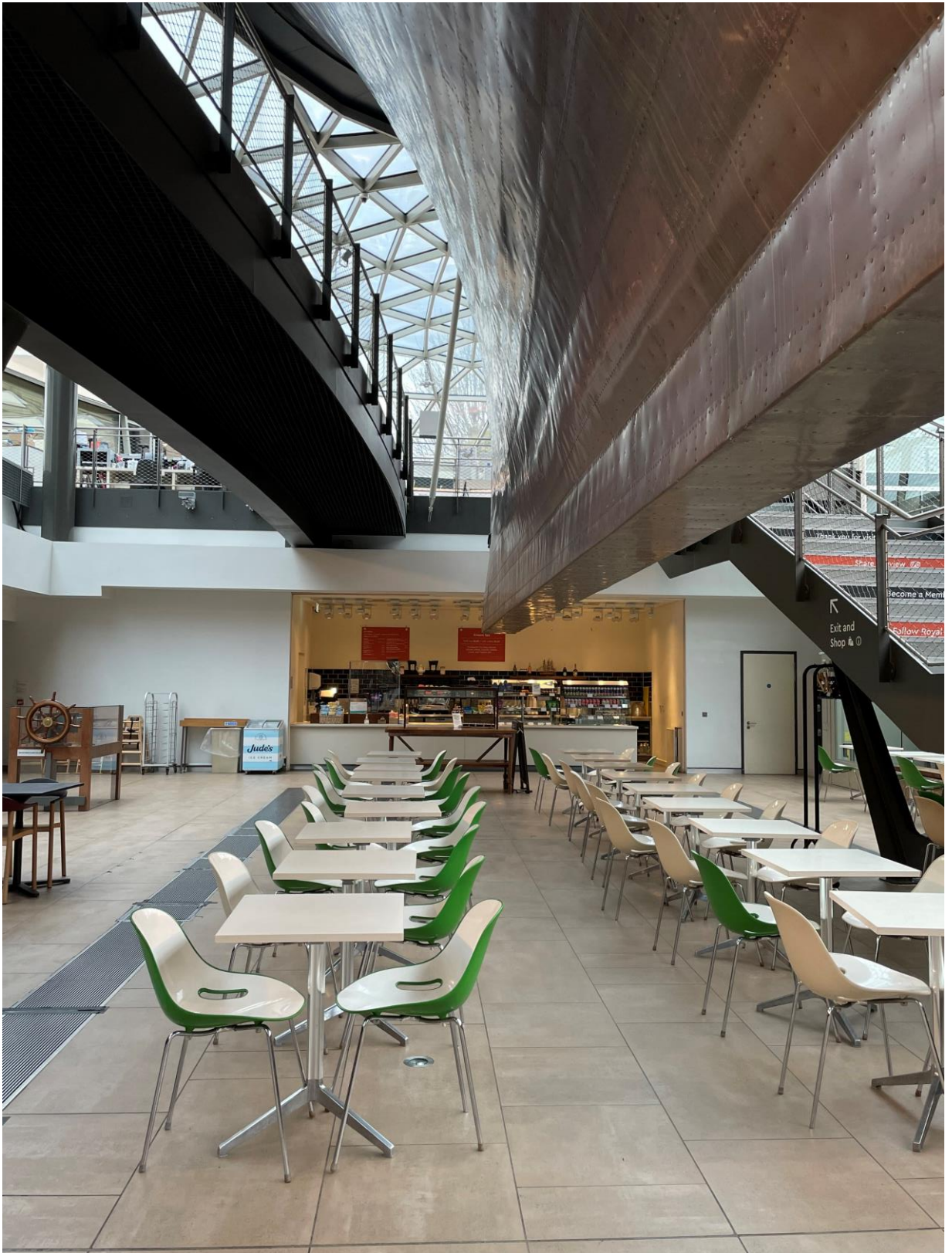

Lifts

- There are a total of 5 lifts on site.
- The two platform lifts situated in *The Dry Berth* providing access from street level to -1, and the internal lift inside the ship are 145cm deep with a doorway width of 0.9m and maximum load of 4 people.
- There is a handrail inside at 90cm height.
- To operate these 3 lifts the button for desired floor must be pushed and held down for the entire duration of the journey.



The two lifts situated in the access tower provide access between *The Main Deck*, street level and level -1.

These lifts are larger – measuring 90cm rail to rail and 215cm door to back handrail. These lifts can be operated by one push of the button. These lifts have a mirror opposite the door for aid in reversing any vehicles.

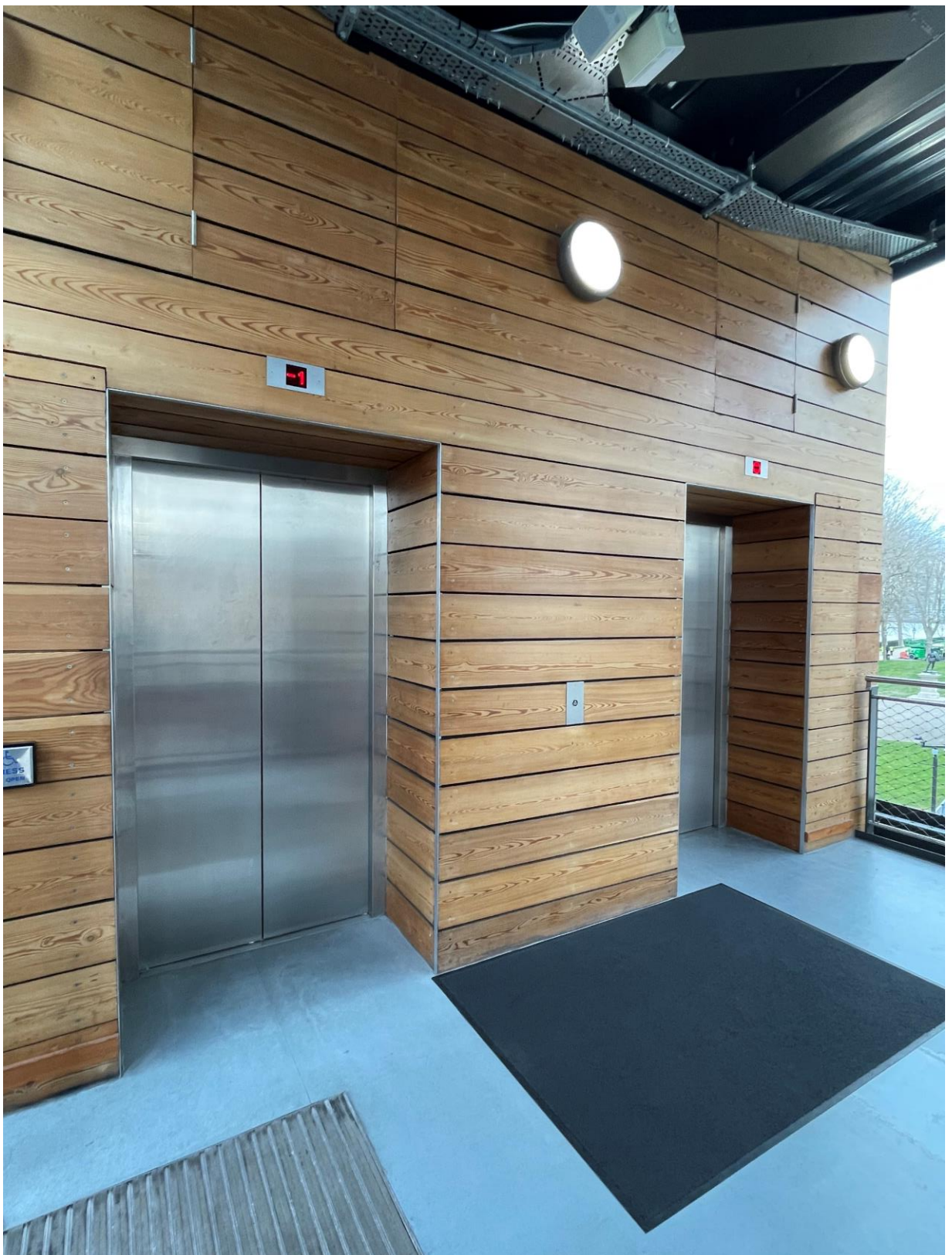

Toilets

The main toilets are located next to the café in *The Dry Berth* underneath the ship.

There is an accessible toilet located at the top of the access tower across the bridge from *The Main Deck*, and a second located next to the main toilets at level - 1 by the café.

There is also an accessible cubicle in both the men's and women's toilets.

- *The doors to each of these open outwards by pulling a handle, which is 0.9m high.*
- *There are horizontal and vertical handrails on the inside of the door at 0.9m high*
- *To lock the door, once closed, turn the handle upwards*
- *The room of the toilet at the top of tower is 1.6m wide while the room of the toilet at the base of tower is 1.5m wide. All other measurements for these 2 rooms match.*
 - *The toilet is at a height of 0.46m*
 - *There is a full length mirror on the left as you enter the toilet*
 - *The sink is at 0.75m height*

In case of emergency or If you require assistance, pull the red cord which hangs by the toilet



Wheelchairs

Wheelchairs for use during your visit are available to reserve in advance, please contact **020 858 4422** with any enquiries.

Please note that:

Assistance is not provided with a wheelchair
The wheelchair cannot be taken off-site, even if
visiting another RMG site

(For health and safety reasons in the case of an emergency evacuation only one wheelchair user can be on each deck of the ship at any one time)

This is a map of *The Cutty Sark* to help you navigate

Map

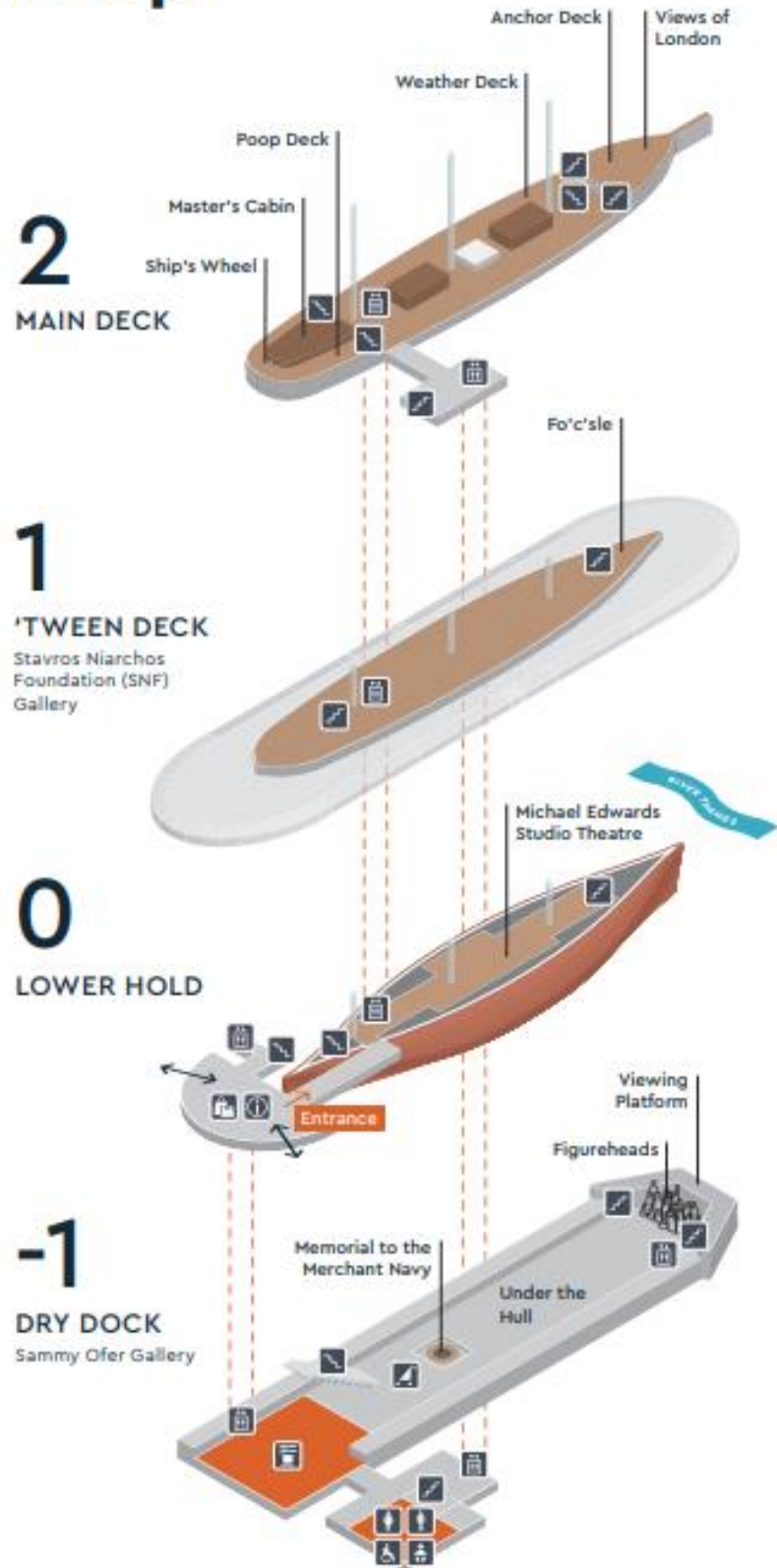

Useful Information

- Ear Defenders are available from the ticket desk on request

- We offer five accessible parking bays for visitors to any of our sites free of charge at this location, and we ask visitors to pre-book a space by contacting the Bookings & Customer Service team on
0208 312 6608
bookings@rmg.co.uk

Disabled parking is also available in Greenwich town centre. Cutty Sark Gardens Car Park (SE10 9HT) is the nearest car park to *Cutty Sark*, and this facility is managed by Greenwich Council. Please find contact details below
020 8921 4339
parking@royalgreenwich.gov.uk

Contact information

For any enquiries regarding tickets or further questions please contact the Bookings department.

The tickets booking office is open 9am – 5pm, Monday to Sunday.

Tel: +44 (0)20 8312 6608 | **Email:** bookings@rmg.co.uk

You can also book tickets online at any time.